

# JB 系列Series

## 低损耗稳幅柔性同轴电缆

- \*Low Loss
- \*Phase & Amplitude Stable
- \*Flexible Coaxial Cable

### 电缆特点

- \*最高工作频率DC-40GHz
- \*温度稳相1000PPM
- \*机械稳相 $\pm 10^\circ$
- \*幅度稳定性 $\pm 0.15\text{dB}$
- \*超低损耗
- \*优良的屏蔽性能

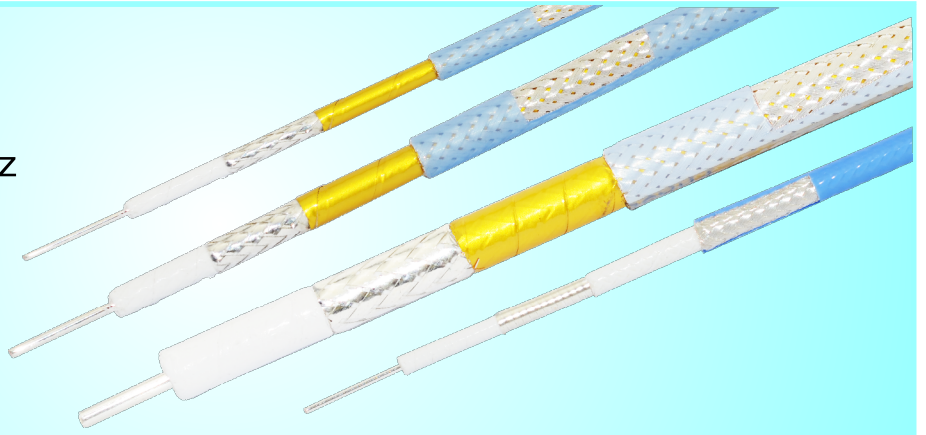

### Features & Advantages

- \*Operating Frequency up to DC-40GHz
- \*Phase Stable 1000PPM
- \*Mechanical Phase Stable $\pm 5^\circ$
- \*Amplitude Stable $\pm 0.15\text{dB}$
- \*Low Loss
- \*Superior Shielding Effectiveness( $< -90\text{dB}$ )

### 典型应用-Applications

- 战术雷达
- 信息通道
- 电子对抗
- 大功率电缆
- 测试平台连接
- 野外测试系统
- 卫星通信
- 测试电缆组件

### 产品介绍-Products Instruction

JB系列电缆采用了特殊的结构设计及先进的生产工艺,使得电缆在全频段范围内有着优良的电气与机械性能,并具有很高的性价比,是低损耗首选方案。

电气性能方面,信号传输率高达76%,温度相位稳定性小于1000PPM,并且还具有低损耗,屏蔽效率高等优点。

机械性能方面,低由于电缆采用扁带编织,使该款电缆有很强的抗扭能力。

环境使用方面,采用耐环境性能优质的外护套原材料使其具有使用温度范围宽、抗腐蚀性、防潮防霉、阻燃等特点。



• Tactical radar



• High power cable



• Satellite Communications

## 低损耗&稳幅稳相柔性同轴电缆

Low Loss, Phase & Amplitude Stable, Flexible High Performance Coax

### 结构材料与尺寸 Material & Construction (可定制尺寸、材料、颜色等)

结构 Structure	材质 Material	JB360	JB460	JB520	JB600
1. 中心导体 (mm) Center Conductor (mm)	镀银铜 Silver Plated Copper	0.72	1.02	1.29	1.57
2. 介质 (mm) Dielectric (mm)	低密度PTFE LD PTFE/ND PTFE	2.21	3.05	3.85	4.72
3. 外导体 (mm) Outer Conductor (mm)	镀银铜带 Silver Plated Copper Ribbon	2.40	3.32	4.15	5.18
4. 中屏蔽 (mm) Innerlayer (mm)	PTFE/LD PTFE	2.80	3.45	4.28	5.30
5. 外屏蔽 (mm) Outer Shields (mm)	镀银铜丝 Silver Plated Copper	3.15	4.02	4.73	5.80
6. 护套 (mm) Jacket (mm)	FEP	3.60	4.60	5.20	6.20

### 主要参数指标 Specifications

主要参数指标 Specifications	JB360	JB460	JB520	JB600
工作频率 Operating Frequency Range (GHz)	40	26.5	26.5	18
特性阻抗 Impedance ( $\Omega$ )	50	50	50	50
传输速率 Vp (%)	76	76	76	76
介质耐压 Voltage Withstand (V, DC)	500	1000	1500	2000
屏蔽效率 Shielding Effectiveness (dB)	<-90	<-100	<-100	<-100
静态弯曲半径 Bend Radius: Installation (mm)	18	18.4	20.8	25.4
动态弯曲半径 Bend Radius: Repeated (mm)	36	46	52	62
重量 Weight (g/m)	34	50	60	90
工作温度范围 Operating Temperature Range ( $^{\circ}\text{C}$ )	-55~165	-55~200	-55~200	-55~200

# 低损耗&稳幅稳相柔性同轴电缆

Low Loss, Phase & Amplitude Stable, Flexible High Performance Coax

## 衰减与频率变化曲线图 Attenuation VS. Frequency

电缆衰减/Cable Attenuation 典型值@ +25° 环境温度

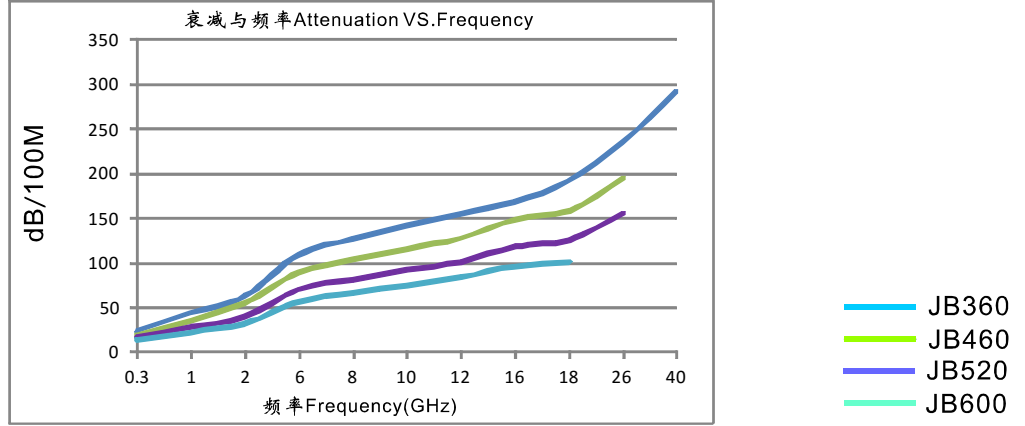

## 衰减与频率 Attenuation VS. Frequency (dB/100m)

Nominal Values @+25° Ambient Temperature

频率 (Mhz) Frequency	300	1000	2000	6000	8000	10000	12000	16000	18000	26500	40000
JB360	23.9	43.8	62.2	108.8	126.1	141.5	155.4	180.43	191.8	234.8	291.7
JB460	19.2	35.4	50.39	88.8	103.2	116	127.7	148.7	158.3	194.9	
JB520	15.01	27.7	39.5	69.9	81.3	91.5	100.9	117.8	125.5	155	
JB600	12	22.2	31.7	56.4	65.8	74.2	81.84	95.8	102.2		

JB360—K1=1.3707349 K2=0.00044 JB460—K1=1.0994853 K2=0.0005906 JB520—K1=0.8562340 K2=0.0005906 JB600—K1=0.682430 K2=0.0005906  
其他任意频点衰减=K1\*sqrt(fMHz)+K2\*fMHz (dB/100m)

## 功率与频率变化曲线图 CW Power VS. Frequency

功率定义/Power Handling: 最大值@ +40° C的环境温度和海平面

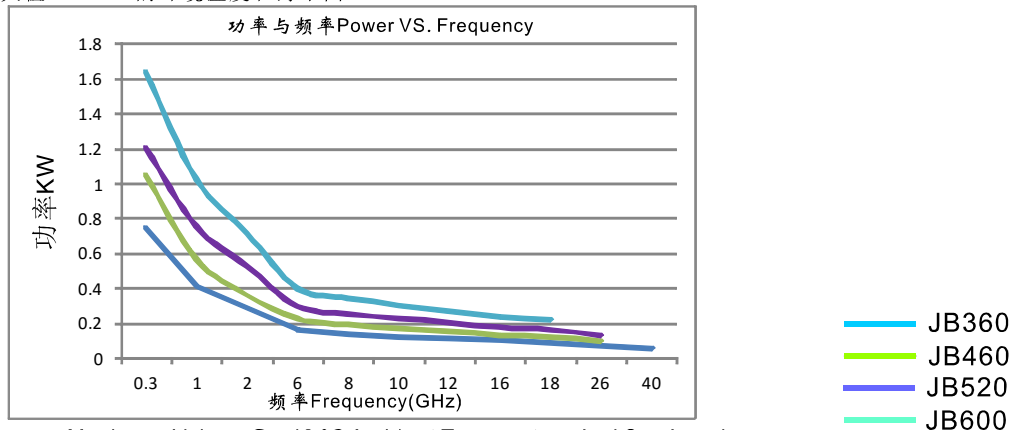

## 功率与频率 (KW) CW Power Handling VS. Frequency

Maximum Values @ +40° C Ambient Temperature And Sea Level

频率 (Mhz) Frequency	300	1000	2000	6000	8000	10000	12000	16000	18000	26500	40000
JB360	0.75	0.409	0.288	0.165	0.142	0.127	0.115	0.106	0.093	0.076	0.061
JB460	1.047	0.569	0.364	0.227	0.195	0.174	0.158	0.135	0.127	0.103	
JB520	1.38	0.754	0.528	0.301	0.256	0.228	0.207	0.177	0.166	0.134	
JB600	1.83	1.024	0.716	0.402	0.345	0.306	0.272	0.237	0.225		

# 低损耗&稳幅稳相柔性同轴电缆

Low Loss, Phase & Amplitude Stable, Flexible High Performance Coax

\*机械相位  
\*Mechanical Phase Stability

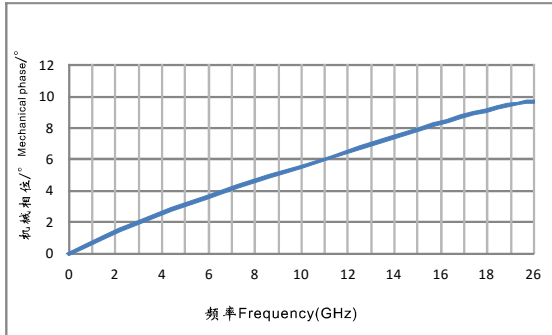

\*温度相位变化 (PPM)  
\*Phase Change vs. Temperature

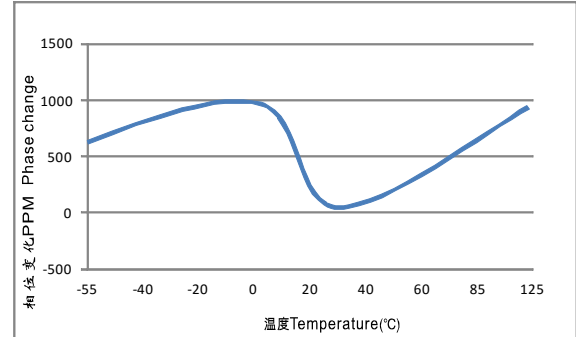

## 部分连接器尺寸图 Connector Outline Drawing

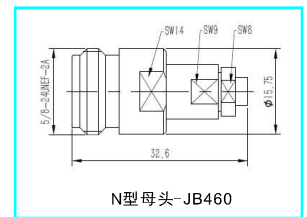
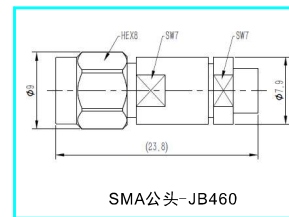
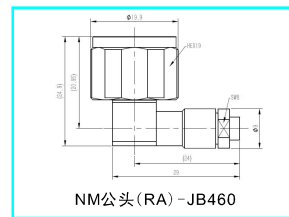
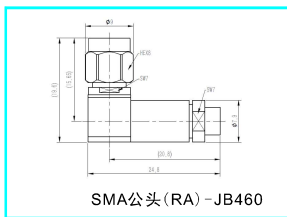
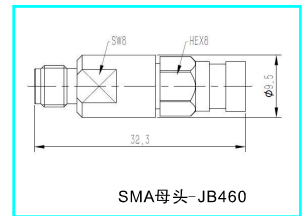
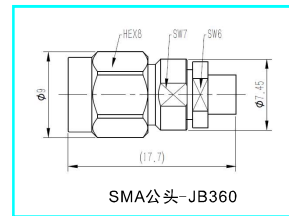
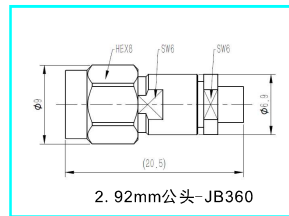
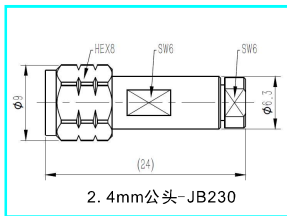

## 适配连接器 Cable Connector Type

连接器 Connector	型号 Type	材料 Material	装接方式 Assembly Type	适用电缆 Applicable to cable
SMA	SMA-XXX	不锈钢SUS-303	焊接/Welding	JB360/JB460/JB520/JB600
N	N-XXX	不锈钢SUS-303	焊接/Welding	JB460/JB520/JB600
2.92mm	29-XXX	不锈钢SUS-303	焊接/Welding	JB360
2.4mm	24-XXX	不锈钢SUS-303	焊接/Welding	JB360

备注Remark:  
XXX表示电缆型号:xxx Refer to Cable Type  
其余形式连接器(如TNC、BNC、SMP等)可定制 Other Type Conector also Available

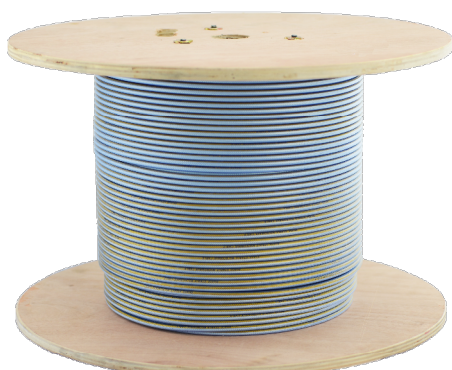

Reel Cable



Cable Assembly